

# COUNTRY VIEW ESTATES

## HOMESITE LAYOUT

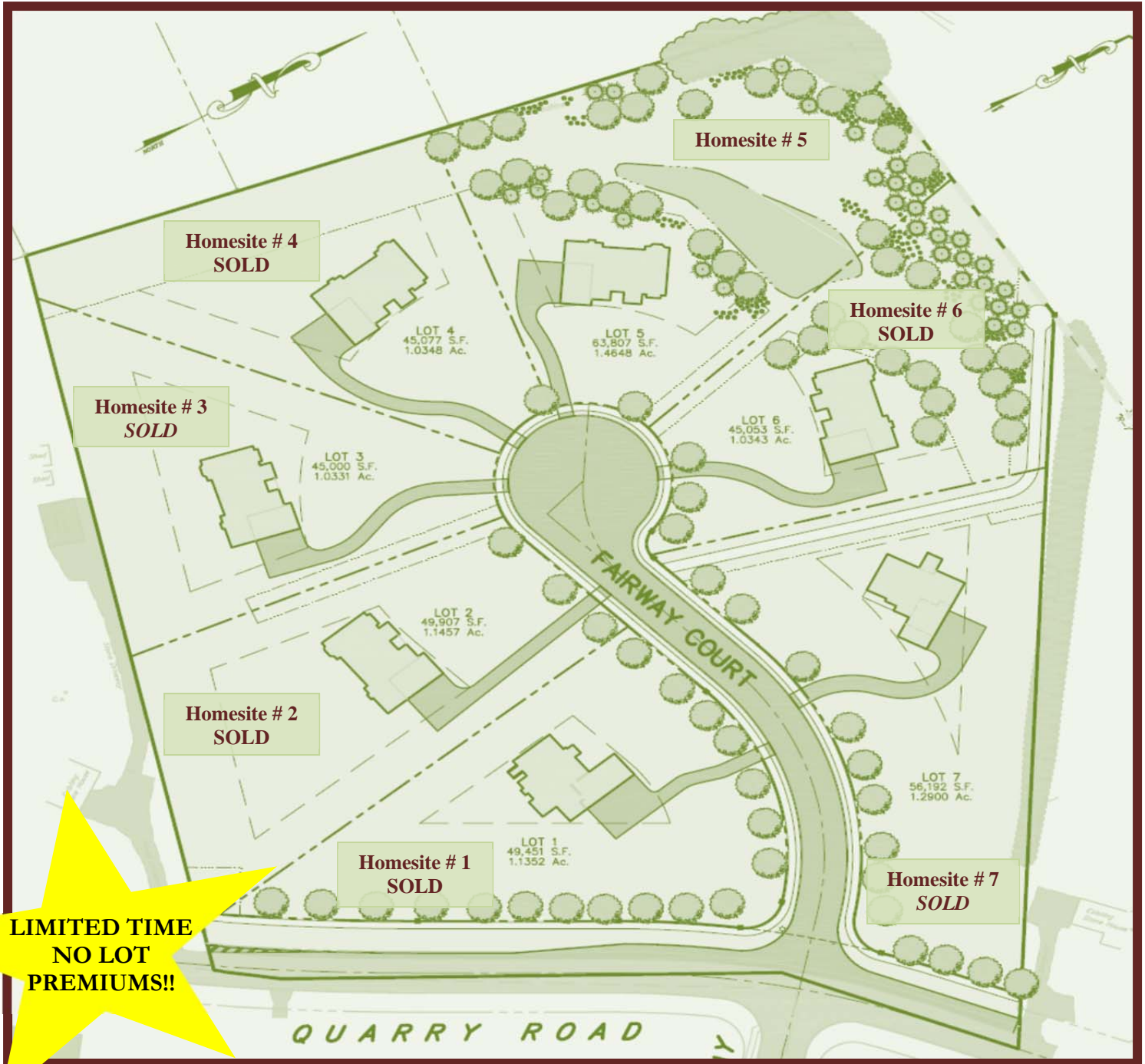

Homesite	Area	Description	Lot Premium	Availability
1	49,451 s.f.	Walk-Out Basement	\$0.00	<i>Sold</i>
2	49,907 s.f.	Walk-Out Basement	\$15,000.00	<i>Sold</i>
3	45,000 s.f.	Walk-Out Basement	\$15,000.00	<i>Sold</i>
4	45,077 s.f.	Walk-Out Basement	\$15,000.00	<i>Sold</i>
5	63,807 s.f.	Daylight Basement	\$0.00	<b><u>Available</u></b>
6	45,053 s.f.	Walk-Out Basement	\$15,000.00	<i>Sold</i>
7	56,192 s.f.	Walk-Out Basement	\$15,000.00	<i>Sold</i>

*Please note that the Walk-Out Basement includes one twin window and one sliding glass door.*